



Finecare™ FIA Meter Plus

Fluorescence Immunoassay Rapid Quantitative Test

- Rapid
- Accurate
- Convenient
- Reliable
- Popular
- Expansive



Fineware™ FIA Meter Plus

Fineware™ FIA Meter Plus is a fluorescence immunochromatographic analysing system which can help diagnose conditions such as infection, diabetes, cardiovascular diseases, renal injury and cancers, etc.

The Fineware™ platform provides reliable and quantitative results of various kinds of analytes in human blood or urine within several minutes.

Application: Laboratory, ER, Cardiology, ICU, Respiratory, Pediatrics, etc.

Test Item

- **Fertility**

β-HCG

- **Infection**

PCT, CRP (hsCRP+CRP),

2 in 1 (CRP+PCT), SAA ^{NEW}

- **Cardiac**

NT-proBNP, cTnI, Myo, CK-MB, H-FABP,

3 in 1 (cTnI + Myo + CK-MB),

2 in 1 (cTnI+NT-ProBNP), ^{NEW} BNP ^{NEW}

- **Diabetes & Renal Injury**

HbA1c, MAU, CysC, NGAL, ^{NEW} β2-MG ^{NEW}

- **Tumor**

AFP, PSA, CEA, fPSA ^{NEW}

- **Coagulation**

D-Dimer

- **Hormone** ^{NEW}

T3, T4, TSH

- **Ongoing**

Estradiol, Cortisol,

Prolactin, Testosterone,

Vitamin-D, Progesterone,

LH, FSH

S100β, ST2,

Lp-PLA2, PAPP-A

Principle and Operation

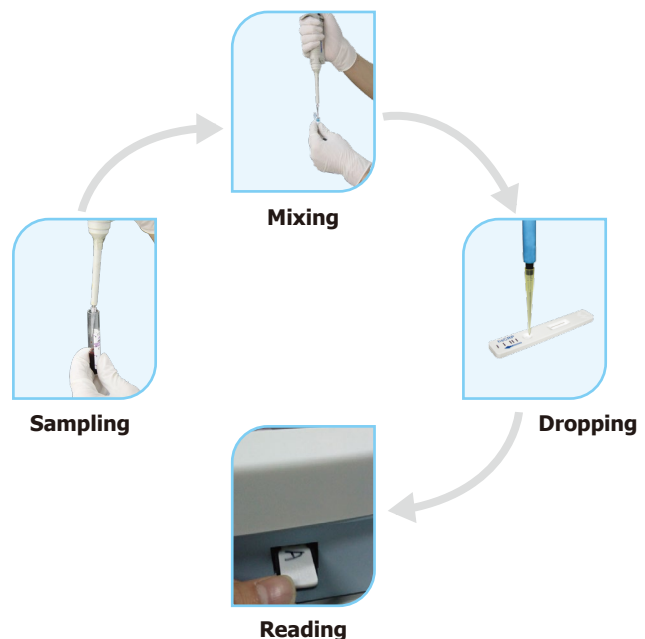
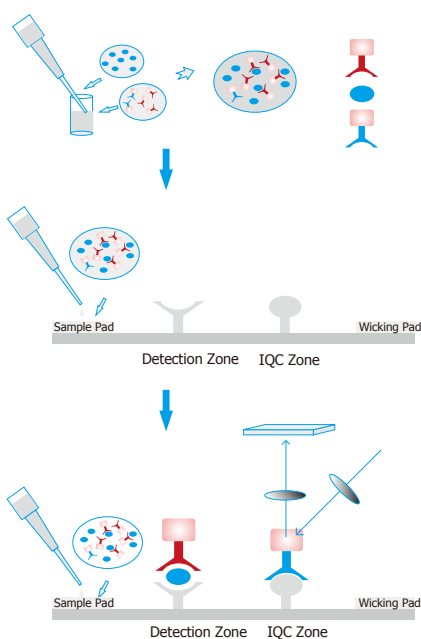

Why Choose Finecare™



Extra quick operating platform for large number of specimens



Powerful information management (Direct connection to LIS/HIS)



Convenient and fast. Get results in 3-15 minutes

Unique quick mode

Designed sampler

Information management

Reliable accuracy

Instant result

Room temperature storage



Specially-designed sampler for small volume of specimen

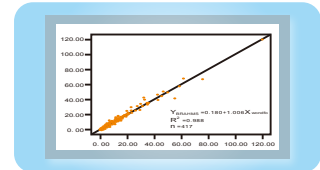

Good correlation with wet chemistry method results

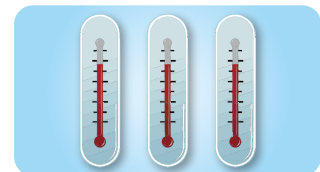

Solid synthetic craft, can be stored at room temperature (4-30 °C)

Built-in Thermal Printer

Real-time printing

8" LCD Touch Screen

Dimensions:

270(L) x 238(W) x 146(H)mm

Weight:

2.8kg

Power adapter:

100-240AC, 50-60Hz

Inner Temperature Control

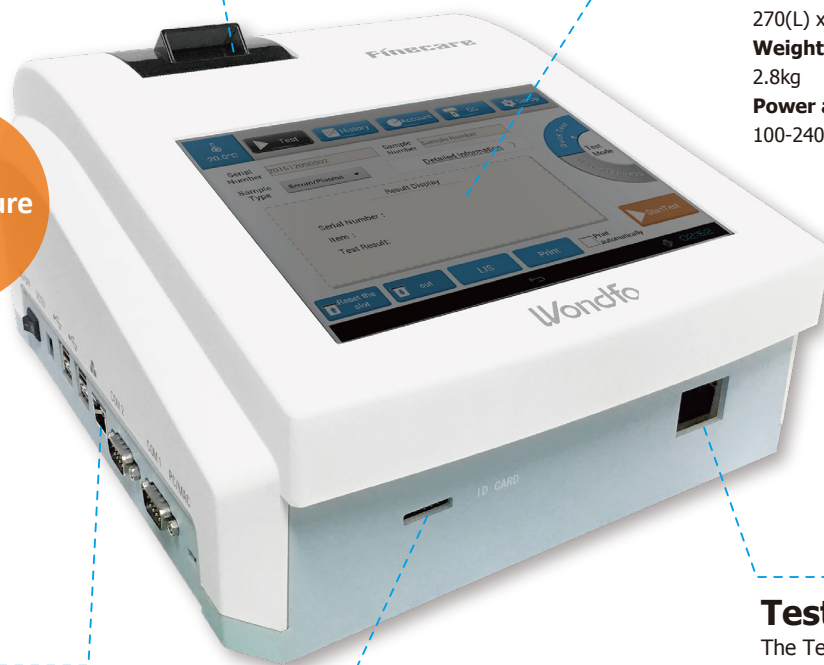

Test Channel

The Test Cartridge Holder

LIS Connection

Direct connection to LIS / HIS

ID Chip Port

The ID chip contains all information of test item and lot number

Product Class	Test Item	Diseases	Specimen Type	Reaction Time	Measuring Range	Clinical Reference	Qualification
Infection	PCT	Sepsis	WB/ Serum / Plasma	15 min	0.1-100 ng/mL	0-0.5 ng/mL	CE
	CRP (hsCRP+CRP)	Inflammation	WB/ Serum / Plasma	3 min	0.5-200 mg/L	CRP:0-10 mg/L hsCRP:0-1 mg/L	CE
	2 in 1 (CRP+PCT)	Infection & Inflammation	WB/ Serum / Plasma	15 min	CRP:0.5-150 mg/L PCT:0.1-100 ng/L	CRP:<10 mg/L PCT:<0.5 ng/L	CE
	SAA ^{NEW}	Infection & Inflammation	WB/ Serum / Plasma	15 min	1.0-300 mg/L	0-10 mg/L	CE
Coagulation	D-Dimer	Thrombosis	WB/Plasma	5 min	0.1-10 mg/L	0-0.5 mg/L	CE
Cardiac	NT-proBNP	Heart Failure	WB/ Serum / Plasma	15 min	18-35000 pg/mL	<75y, 0-300 pg/mL ≥75y, 0-450 pg/mL	CE
	cTnI	Myocardial Infarction	WB/ Serum / Plasma	15 min	0.1-50 ng/mL	0-0.3 ng/mL	CE
	Myo	Myocardial Infarction	WB/ Serum / Plasma	15 min	2.0-400 ng/mL	0-58 ng/mL	CE
	CK-MB	Myocardial Infarction	WB/ Serum / Plasma	15 min	0.3-100 ng/mL	0-5 ng/mL	CE
	H-FABP	Myocardial Infarction	WB/ Serum / Plasma	15 min	1-120 ng/mL	0-7 ng/mL	CE
	3 in 1 (cTnI/ Myo / CK-MB)	Myocardial Infarction	WB/ Serum / Plasma	15 min	Same with single items	Same with single items	CE
	BNP ^{NEW}	Heart Failure	WB/ Plasma	15 min	5-5000 pg/mL	0-100 pg/mL	CE
	2 in 1 ^{NEW} (cTnI/ NT-proBNP)	Myocardial Infarction	WB/ Serum / Plasma	15 min	Same with single items	Same with single items	CE
Tumor	AFP	Liver Cancer	Serum	15 min	5-400 ng/mL	0-20 ng/mL	CE
	PSA	Prostate Cancer	Serum	15 min	2-100 ng/mL	0-4 ng/mL	CE
	CEA	Cancer	WB/ Serum / Plasma	15 min	1-500 ng/mL	0-5 ng/mL	CE
Diabetes & Renal Injury	HbA1c	Diabetes Mellitus	WB	5 min	4.0-14.5%	4-6%	CE IFCC NGSP
	MAU	Renal Injury	Urine	3 min	5-300 mg/L	0-20 mg/L	CE
	CysC	Renal Injury	WB/ Serum / Plasma	5 min	0.2-10 mg/L	0.5-1.1 mg/L	CE
	NGAL ^{NEW}	Renal Injury	Urine	15 min	10-1500 ng/mL	≤131.7 ng/mL	CE
	β2-MG ^{NEW}	Proximal Renal Tubule Dysfunction	WB/ Serum / Plasma	10 min	0.3-20 mg/L	1.0-2.7 mg/L	CE
Fertility	β-hCG	Fertility	WB/ Serum / Plasma	15 min	2-200,000 mIU/mL	5 mIU/mL	CE
Hormone ^{NEW}	T3	Thyroid Malfunction	WB/ Serum / Plasma	15 min	0.61-9.22 nmol/L	1.3-3.1 nmol/L	CE
	T4	Thyroid Malfunction	WB/ Serum / Plasma	15 min	12.87-300 nmol/L	66-181 nmol/L	CE
	TSH	Thyroid Malfunction	WB/ Serum / Plasma	15 min	0.1-100 mIU/L	0.3-4.2 mIU/L	CE